

# LAKE SURVEY MAP

TAYLOR COUNTY FOREST

Rib Lake 6 miles

D.N.R. B.M. 'X' 1441-A  
Is A Brass cap set in concrete post  
Located at Boat landing 105' W.  
of waters edge, 99' S. of camp water  
pump in circular turn around  
Assumed elevation 100.00'  
Water level 84.58'

14 13  
23 24

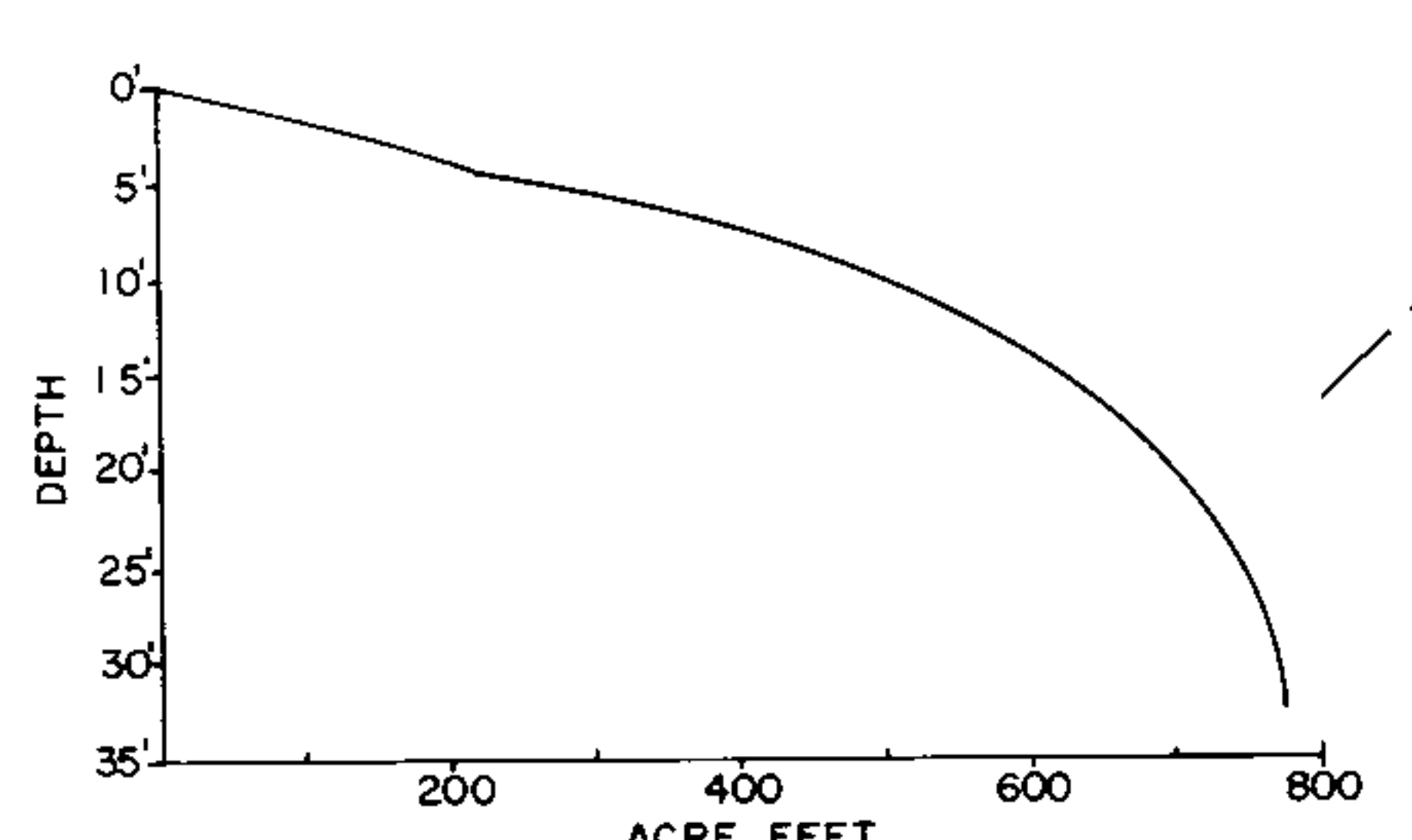
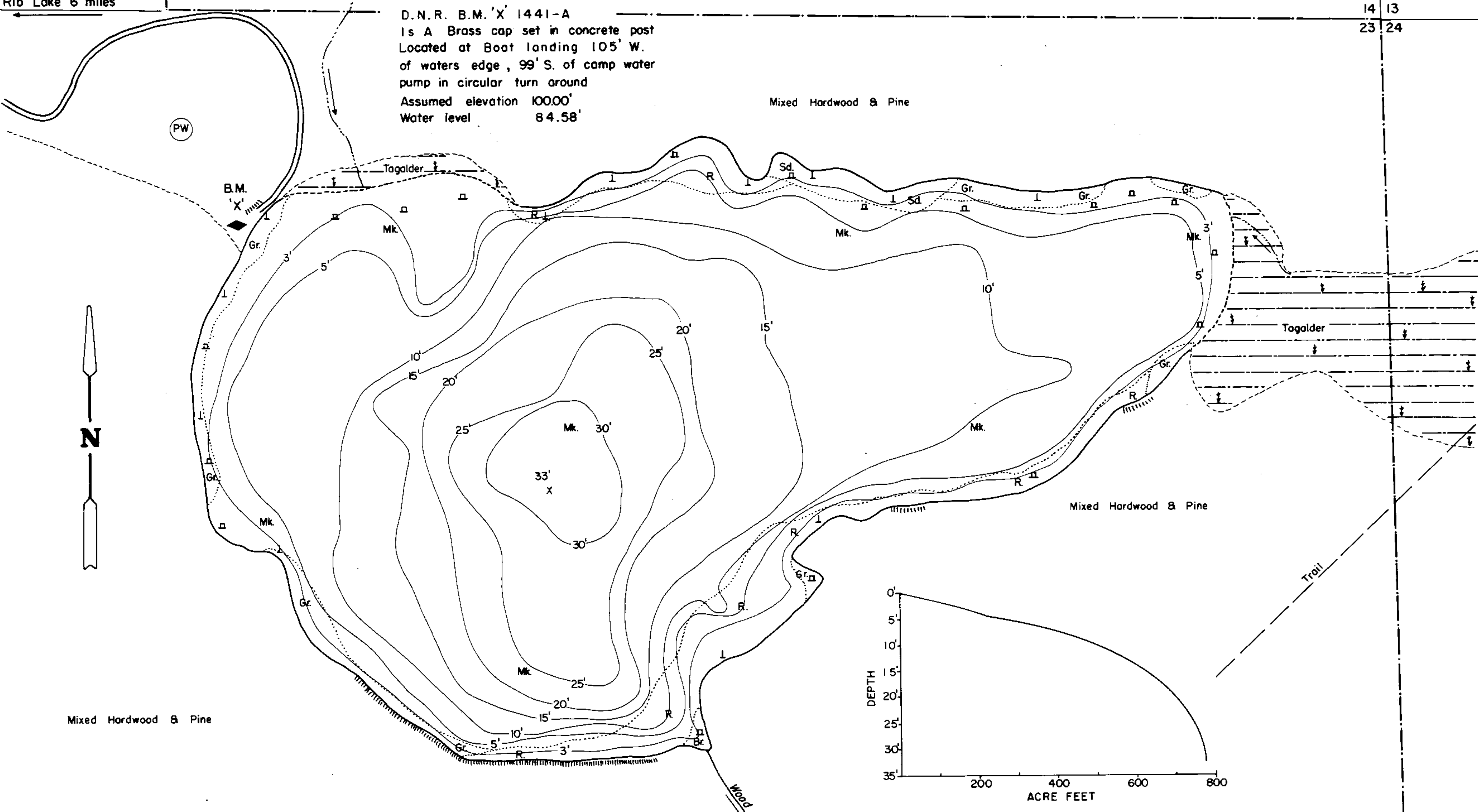

EQUIPMENT RECORDING SONAR MAPPED		JUNE 1969	
TOPOGRAPHIC SYMBOLS		MONTH	YEAR
		LAKE	BOTTOM
(B) Brush	Steep slope	P. Peat	B Boulders
(PW) Partially wooded	~ Indefinite shoreline	Mk. Muck	⊙ Stumps & Snags
(W) Wooded	~ Marsh	C. Clay	⊙ Rock danger to navigation
(C) Cleared	~ Spring	M. Marl	T Submergent vegetation
(P) Pastured	~ Intermittent stream	Sd. Sand	↓ Emergent vegetation
(A) Agricultural	~ Permanent inlet	St. Silt	⊙ Floating vegetation
B.M. Bench Mark	~ Permanent outlet	Gr. Gravel	⊙ Brush shelters
■ Dwelling	~ Dam	R. Rubble	
■ Resort	~ D.N.R. State owned land	Bc Bedrock	
■ Camp			



Access Access with Parking Boat Livery  
Drawn by: C. Holt  
Field work by: C. Busch, C. Belter, S. Johannes

SPECIES OF FISH	ABUNDANCE		
	Abundant	Common	Present
Muskie			X
N. Pike			X
Walleye			X
L.M. Bass	X		
S.M. Bass			
Panfish	X		
Trout			

WATER AREA 62.5 ACRES  
UNDER 3 FT. 12%  
OVER 20 FT. 21%  
MAX. DEPTH 33 FEET.  
TOTAL ALK. 16 P.P.M.  
VOLUME 775.1 ACRE FT.  
SHORELINE 1.43 MILES

Source: Wisconsin Department of Natural Resources 608-266-2621  
Wood Lake – Taylor County, Wisconsin DNR Lake Map  
Date – Jun 1969 - Historical Lake Map - Not for Navigation  
A Public Document - Please Identify the Source when using it.